

Tutorial - Curved Corners

How to curve/round the corners of an image.

Step 1: Open the image you wish to use.

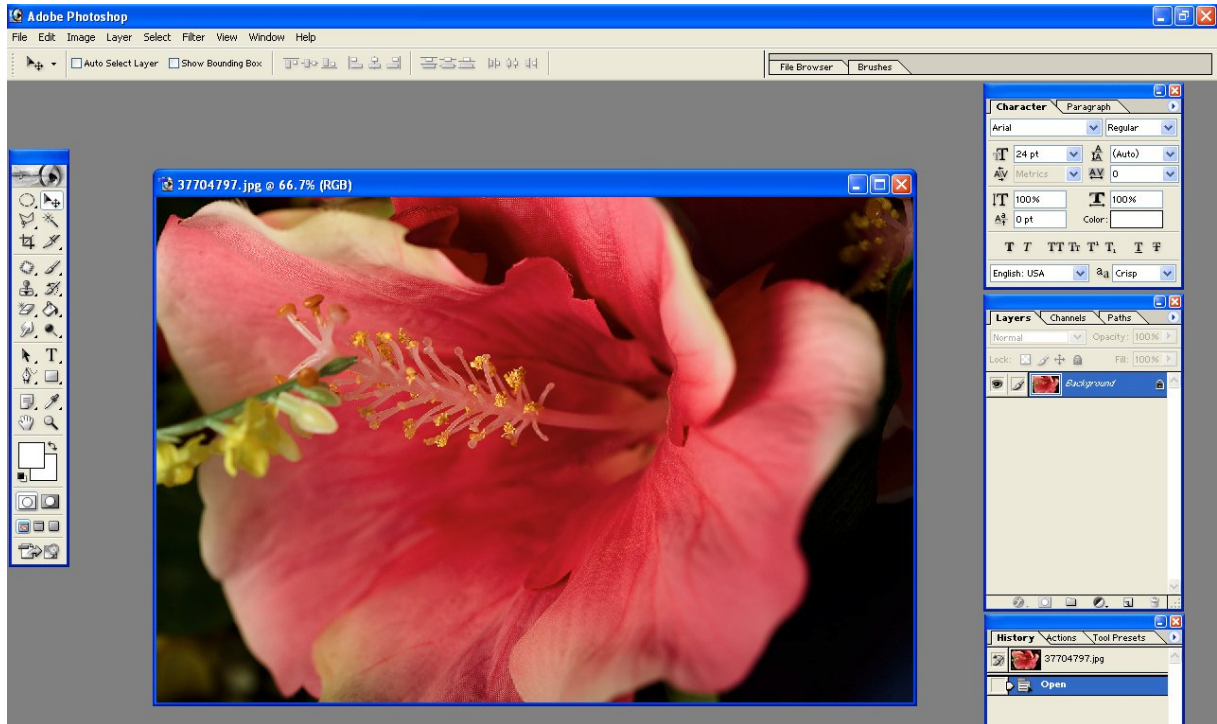

Step 2: Select the Rounded Rectangular Tool from the Tools menu. Now on the top menu you will see options for the rectangular tool. Select the Paths icon.

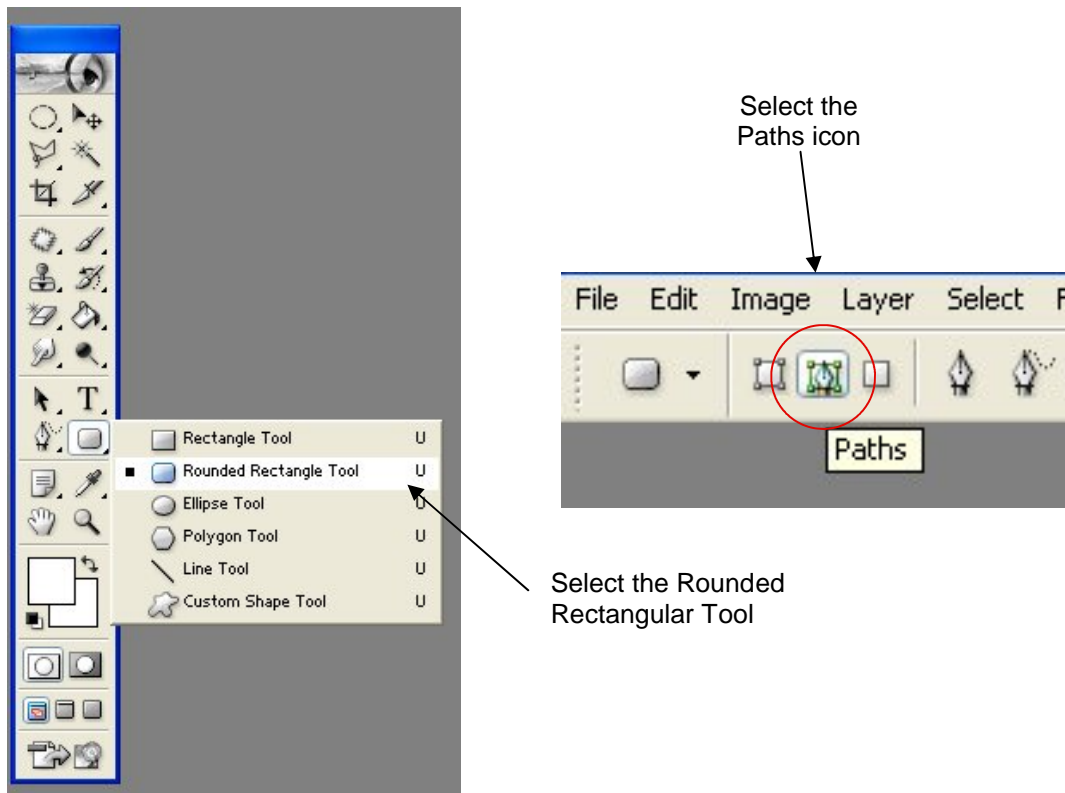

Step 3: Place the cursor in the top left hand corner. Holding the left mouse button down drag the box that appears on the screen until you reach the bottom right hand corner.

From here

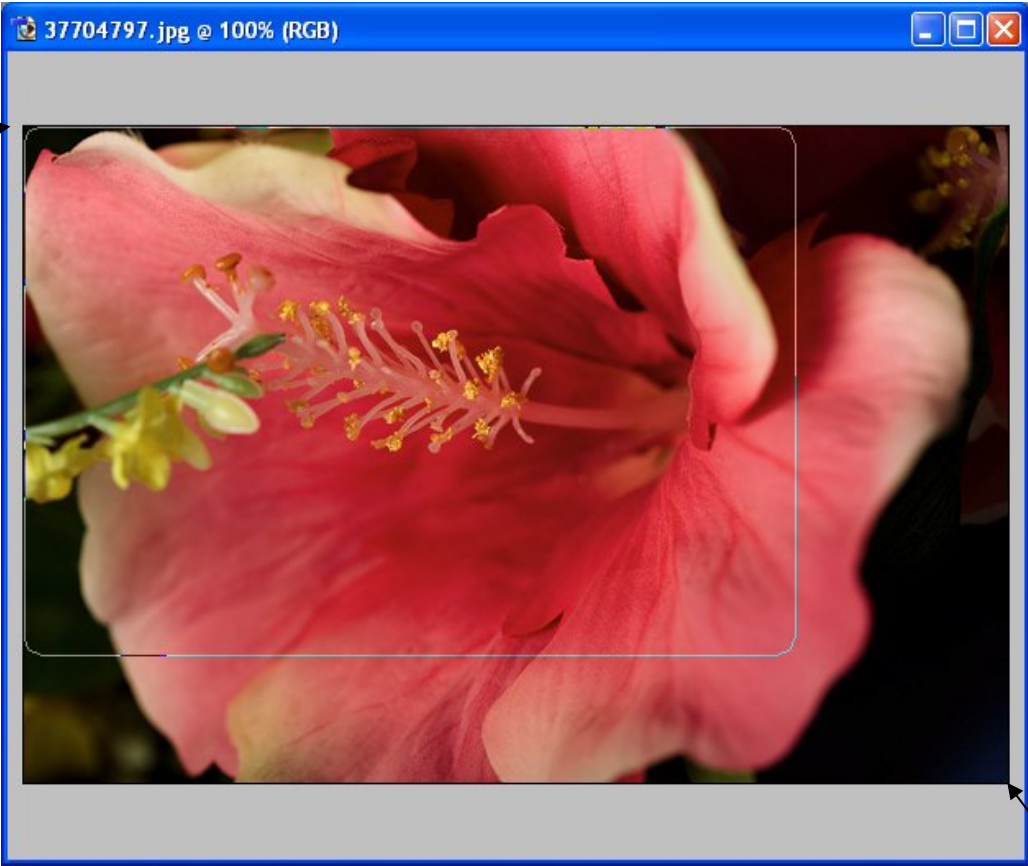

To here

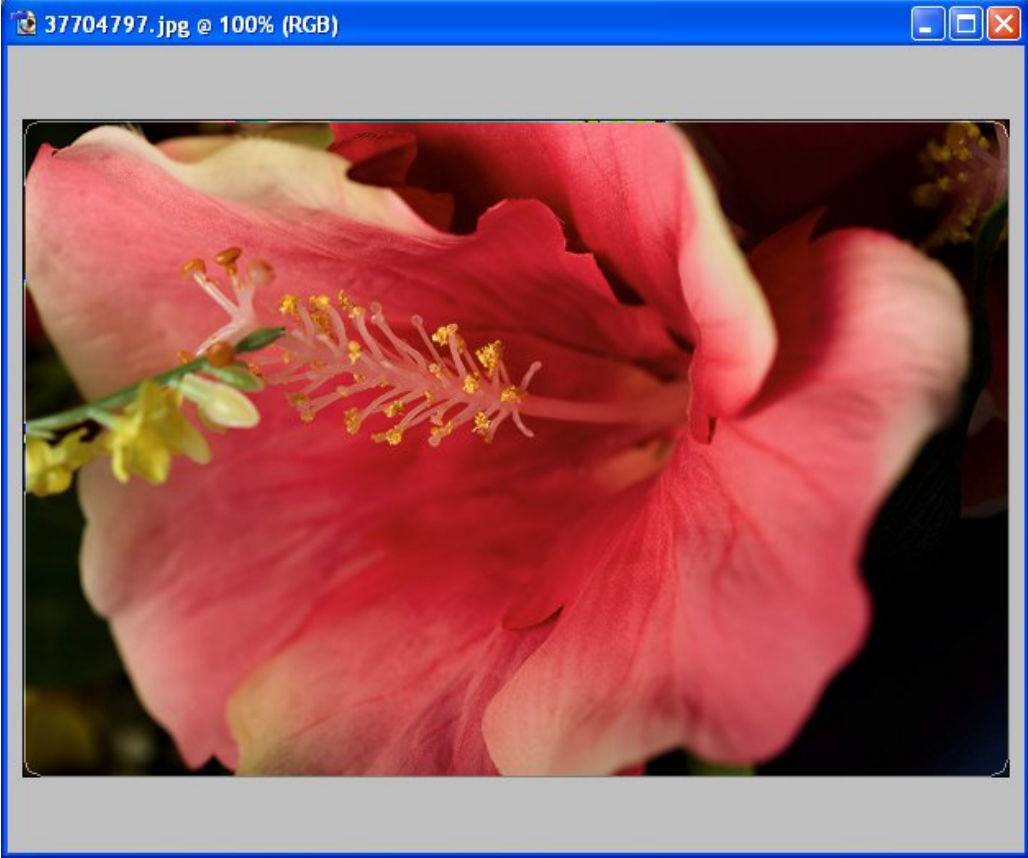

Step 4: Now select the Paths tab on the layers menu and then click on the third circle from the left (Load path as a selection).

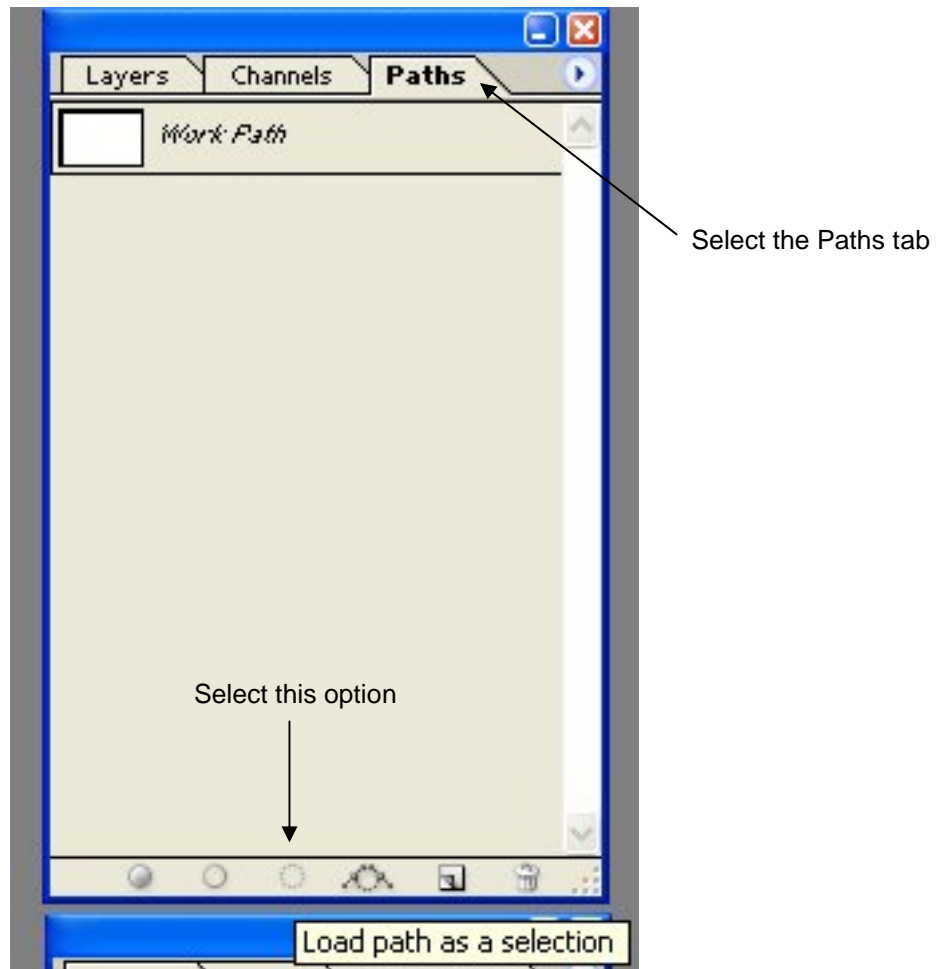

Step 5: From the main menu at the top of the screen click on Select and then Inverse.

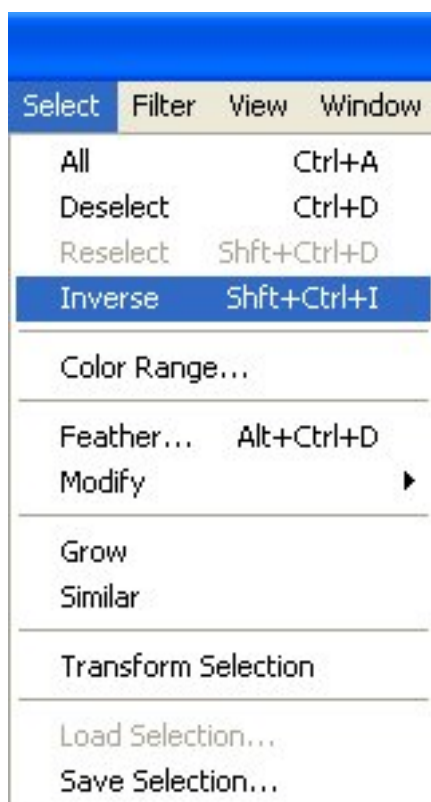

Step 6: This is the last step. Click on Edit from the main menu and select Cut. (Or you can simply press Ctrl+X on your keyboard).

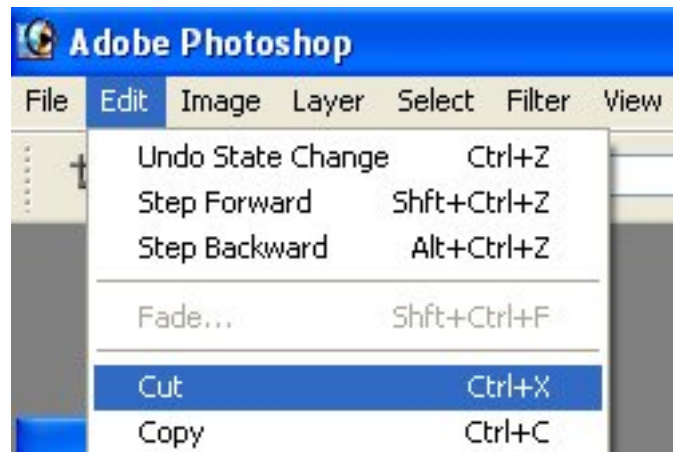

And that's it! You should now have an image with rounded corners. Here is our finished image:

